

HQS2GWHC

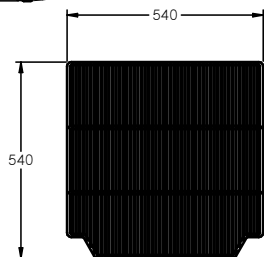

| | |
|----------|--------------------|
| CATEGORY | GENERAL UPRIGHTS |
| RANGE | Quartz Star |
| UNIT | REFRIGERATOR |
| TYPE | SELF CONTAINED |
| DOORS | 2 |

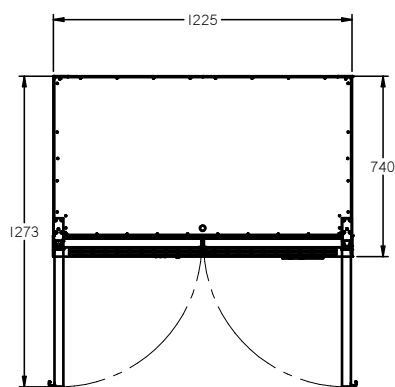

SHELF DETAIL

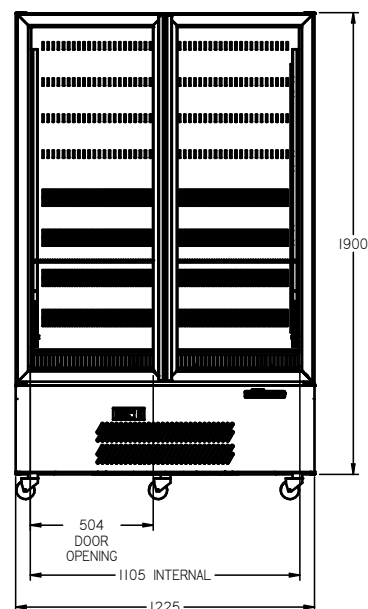
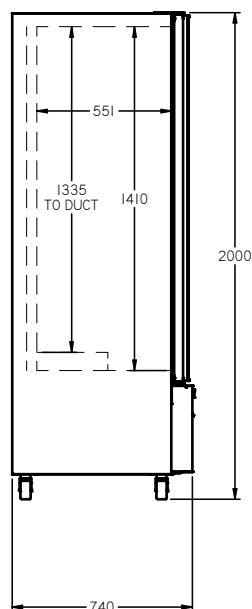

SPECIFICATIONS

| | |
|---|-------------------------|
| CAPACITY LITRES | 900 |
| TEMPERATURE | 1°C / 4°C |
| DIMENSIONS - W X D X H (ON 120 MM H CASTORS) MM | 1225 W x 740 D x 2000 H |
| WEIGHT UNPACKED (KG) | 230 |

STANDARD INCLUSIONS ***

| | |
|---|---|
| DOOR TYPE | G (Glass Door), Optional: PT (Pass Through) |
| FINISH (INTERIOR AND EXTERIOR EXCLUDING REAR AND UNDER) | W (White) |
| SHELVES/DOOR (ADJUSTABLE STRIPS AND CLIPS) | 4 |

GAS TYPE

| | |
|-------------|------|
| REFRIGERANT | R290 |
|-------------|------|

ELECTRICAL

| | |
|-----------------------------|--------|
| POWER SUPPLY | 10 amp |
| POWER CABLE LENGTH (METRES) | 2 |
| RUNNING AMPS | 2.8 |

PERFORMANCE

| | |
|------------------|---------------------|
| KWH/24HR READING | 4.55 |
| TEST STANDARD | ISO 23953 (Display) |
| TEST CONDITIONS | 3 M1 |
| AMBIENT RATING | 43°C |

REFRIGERATION WATTAGES FOR OPTIONAL REMOTE UNITS

| | |
|-------------------------------------|----------------|
| FRIDGE MODELS - GLASS DOORS (R404A) | 760 @ -5°C SST |
|-------------------------------------|----------------|

*** For **OPTIONS** refer to the current Williams Price Guide